

4 PIN SOP HIGH VOLTAGE DARLINGTON PHOTOTRANSISTOR PHOTOCOUPLER

EL452-G Series

Features:

- Halogens free
- High collect-Emitter voltage ($V_{CEO} = 350V$)
- Current transfer ratio
(CTR: Min. 1000% at $I_F = 1mA$, $V_{CE} = 2V$)
- High isolation voltage between input and output ($V_{iso} = 3750 V rms$)
- Compact 4 Pin SOP with a 2.0 mm profile
- Pb free and RoHS compliant.
- UL approved (Pending)
- VDE approved (Pending)
- SEMKO approved (Pending)
- NEMKO approved (Pending)
- DEMKO approved (Pending)
- FIMKO approved (Pending)
- CSA approved (Pending)



Description

The EL452-G contains an infrared emitting diode, optically coupled to a high voltage darlington phototransistor. It is packaged in a 4-pin small outline SMD package.

Schematic

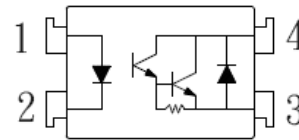

Pin Configuration

1. Anode
2. Cathode
3. Emitter
4. Collector

Applications

- Telephone set, telephone exchangers
- Sequence controllers
- System appliances, measuring instruments
- Signal transmission between circuits of different potentials and impedance

4 PIN SOP HIGH VOLTAGE DARLINGTON PHOTOTRANSISTOR PHOTOCOUPLER

EL452-G Series

Absolute Maximum Ratings ($T_a=25^\circ\text{C}$)

Parameter		Symbol	Rating	Unit
Input	Forward current	I_F	60	mA
	Peak forward current ($t = 10\mu\text{s}$)	I_{FM}	1	A
	Power dissipation	P_D	100	mW
Output	Power dissipation	P_C	150	mW
	Collector current	I_C	150	mA
	Collector-Emitter voltage	V_{CEO}	350	V
	Emitter-Collector voltage	V_{ECO}	0.1	V
Total power dissipation		P_{tot}	170	mW
Isolation voltage ^{*1}		V_{iso}	3750	V rms
Operating temperature		T_{opr}	-55~+110	$^\circ\text{C}$
Storage temperature		T_{stg}	-55~+125	$^\circ\text{C}$
Soldering temperature ^{*2}		T_{sol}	260	$^\circ\text{C}$

Notes

*1 AC for 1 minute, R.H.= 40 ~ 60% R.H. In this test, pins 1 & 2 are shorted together, and pins 3 & 4 are shorted together.

*2 For 10 seconds.

4 PIN SOP HIGH VOLTAGE DARLINGTON PHOTOTRANSISTOR PHOTOCOUPLER

EL452-G Series

Electrical Characteristics (T_a=25°C unless specified otherwise)

Input

Parameter	Symbol	Min.	Typ.*	Max.	Unit	Condition
Forward voltage	V _F	-	1.2	1.4	V	I _F = 10mA
Reverse current	I _R	-	-	10	μA	V _R = 4V
Input capacitance	C _{in}	-	50	-	pF	V = 0, f = 1KHz

Output

Parameter	Symbol	Min.	Typ.*	Max.	Unit	Condition
Collector-Emitter dark current	I _{CEO}	-	-	100	nA	V _{CE} = 200V, I _F =0mA
Collector-Emitter breakdown voltage	BV _{CEO}	350	-	-	V	I _C =0.1mA
Emitter-Collector breakdown voltage	BV _{ECO}	0.1	-	-	V	I _E =0.01mA

Transfer Characteristics (T_a=25°C unless specified otherwise)

Parameter	Symbol	Min.	Typ.*	Max.	Unit	Condition
Current Transfer ratio	CTR	1000	2000	-	%	I _F = 1mA, V _{CE} = 2V
Collector-emitter saturation voltage	V _{CE(sat)}	-	1.2	1.5	V	I _F = 20mA, I _C = 100mA
Isolation resistance	R _{IO}	5×10 ¹⁰	10 ¹¹	-	Ω	V _{IO} = 500Vdc, 40~60%R.H
Cut-off frequency	f _c	-	7	-	KHz	V _{CE} =2V, I _C =2mA, R _L =100Ω, -3db
Floating capacitance	C _{IO}	-	0.6	-	pF	V _{IO} = 0, f = 1MHz
Rise time	T _r	-	80	250	μs	V _{CE} =2V, I _C =20mA, R _L =100Ω
Fall time	T _f	-	10	100	μs	

* Typical values at T_a = 25°C

Typical Performance Curves

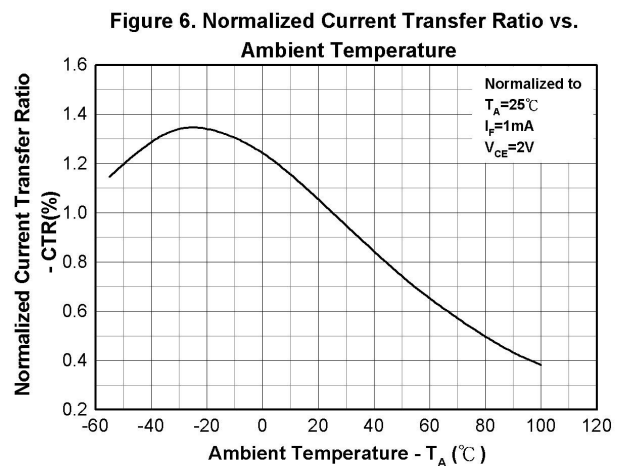
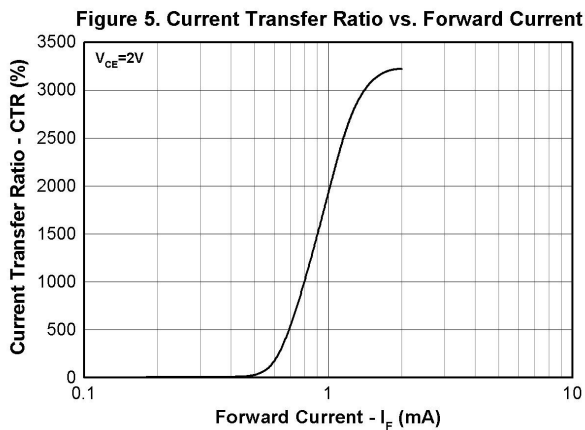
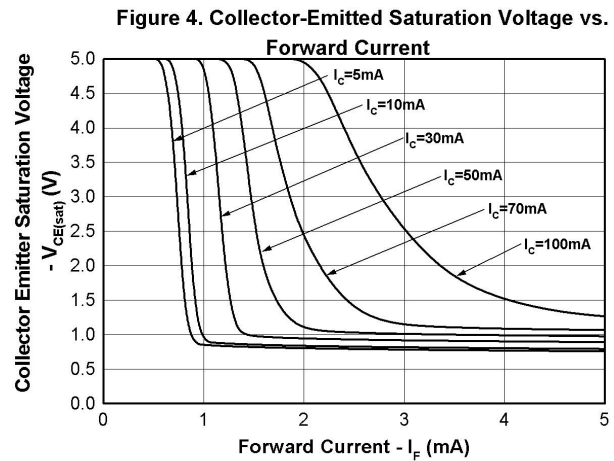
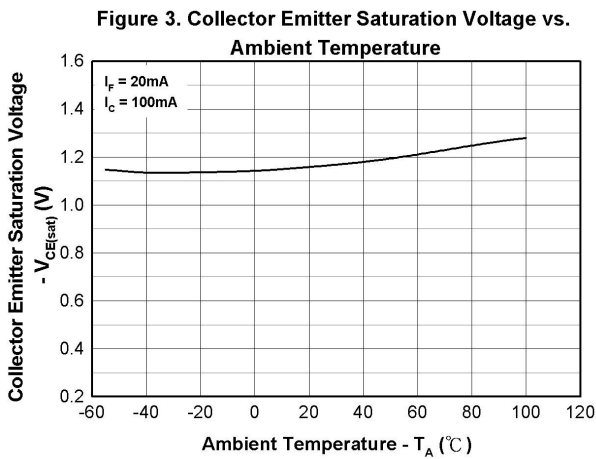
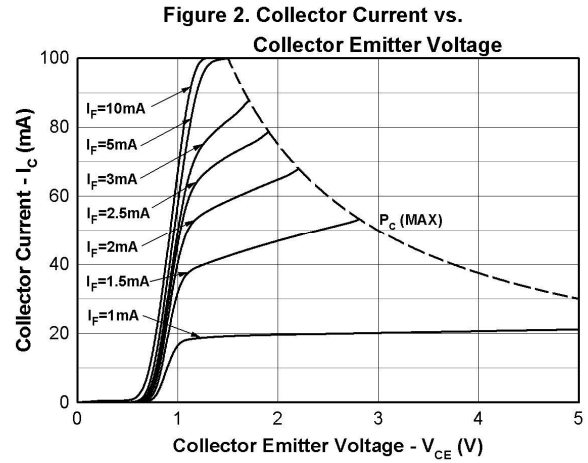
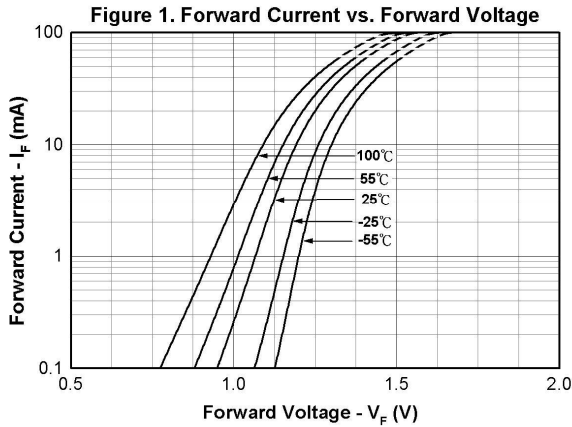

Figure 7. Collector Dark Current vs. Ambient Temperature

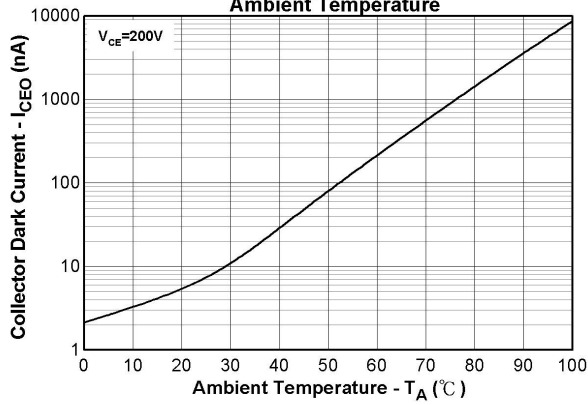

Figure 8. Response Time vs. Load Resistance

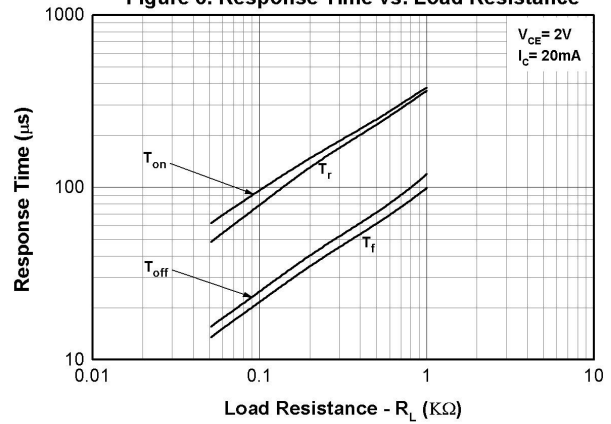
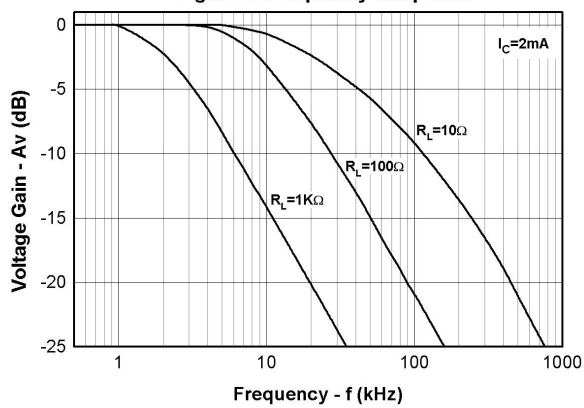

Figure 9. Frequency Response



4 PIN SOP HIGH VOLTAGE DARLINGTON PHOTOTRANSISTOR PHOTOCOUPLER

EL452-G Series

Order Information

Part Number

EL452(Y)-VG

Note

Y = Tape and reel option (TA, TB, or none).

V = VDE safety (optional)

G = Halogens free

Option	Description	Packing quantity
None	Standard SMD option	100 units per tube
-V	Standard SMD option + VDE	100 units per tube
(TA)	TA Tape & reel option	3000 units per reel
(TB)	TB Tape & reel option	3000 units per reel
(TA)-V	TA Tape & reel option + VDE	3000 units per reel
(TB)-V	TB Tape & reel option + VDE	3000 units per reel

4 PIN SOP HIGH VOLTAGE DARLINGTON PHOTOTRANSISTOR PHOTOCOUPLER

EL452-G Series

Package Drawings

(Dimensions in mm)

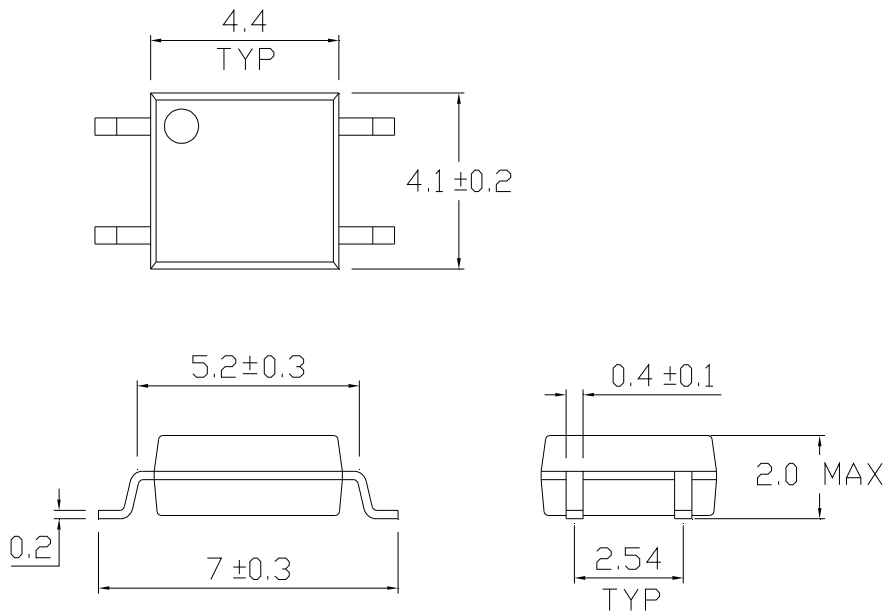

Recommended pad layout for surface mount leadform

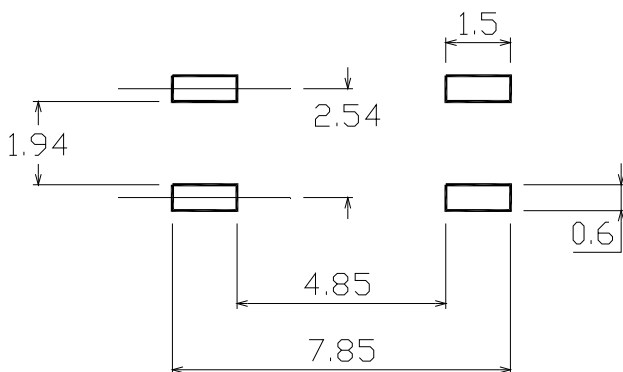

Device Marking



Notes

EL	denotes Everlight
452	denotes Part Number
Y	denotes 1 digit Year code
WW	denotes 2 digit Week code
V	denotes VDE approved (optional)

4 PIN SOP HIGH VOLTAGE DARLINGTON PHOTOTRANSISTOR PHOTOCOUPLER

EL452-G Series

Tape & Reel Packing Specifications

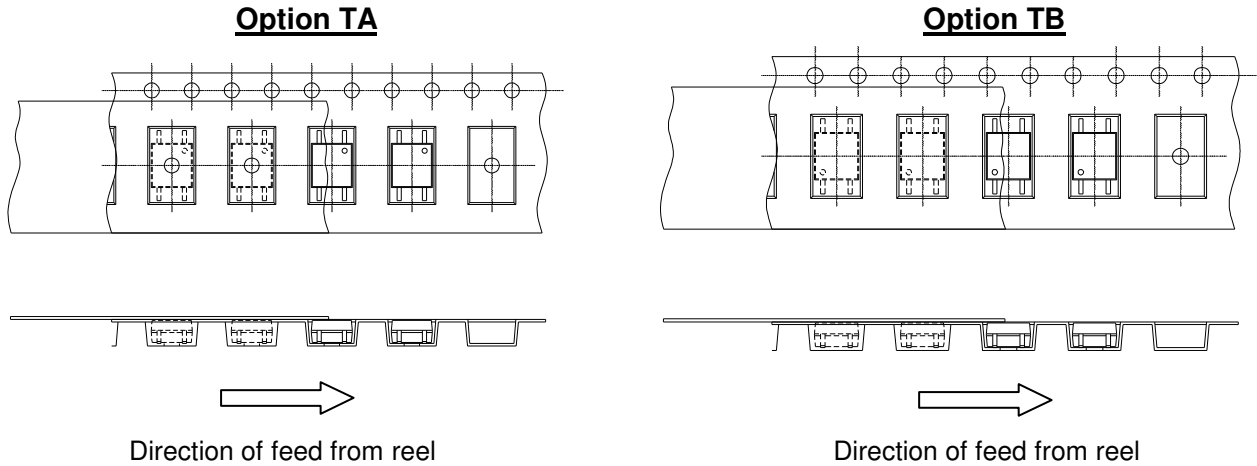

Tape dimensions

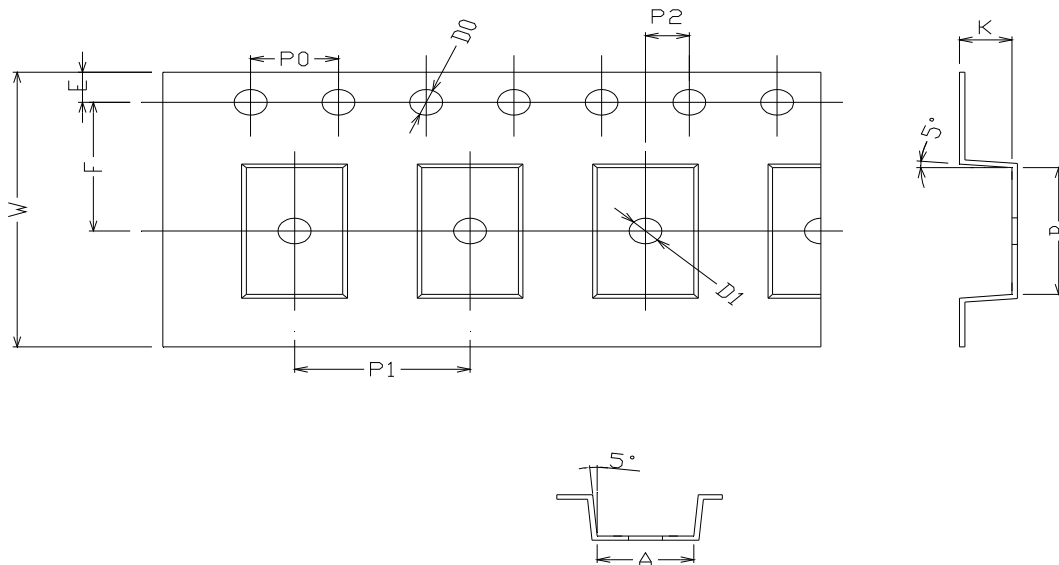

Dimension No.	A	B	Do	D1	E	F
Dimension (mm)	4.4 ± 0.1	7.4 ± 0.1	1.5 + 0.1/-0	1.5 ± 0.1	1.75 ± 0.1	7.5 ± 0.1
Dimension No.	Po	P1	P2	t	W	K
Dimension (mm)	4.0 ± 0.15	8.0 ± 0.1	2.0 ± 0.1	0.25 ± 0.03	16.0 ± 0.2	2.4 ± 0.1

Solder Reflow Temperature Profile

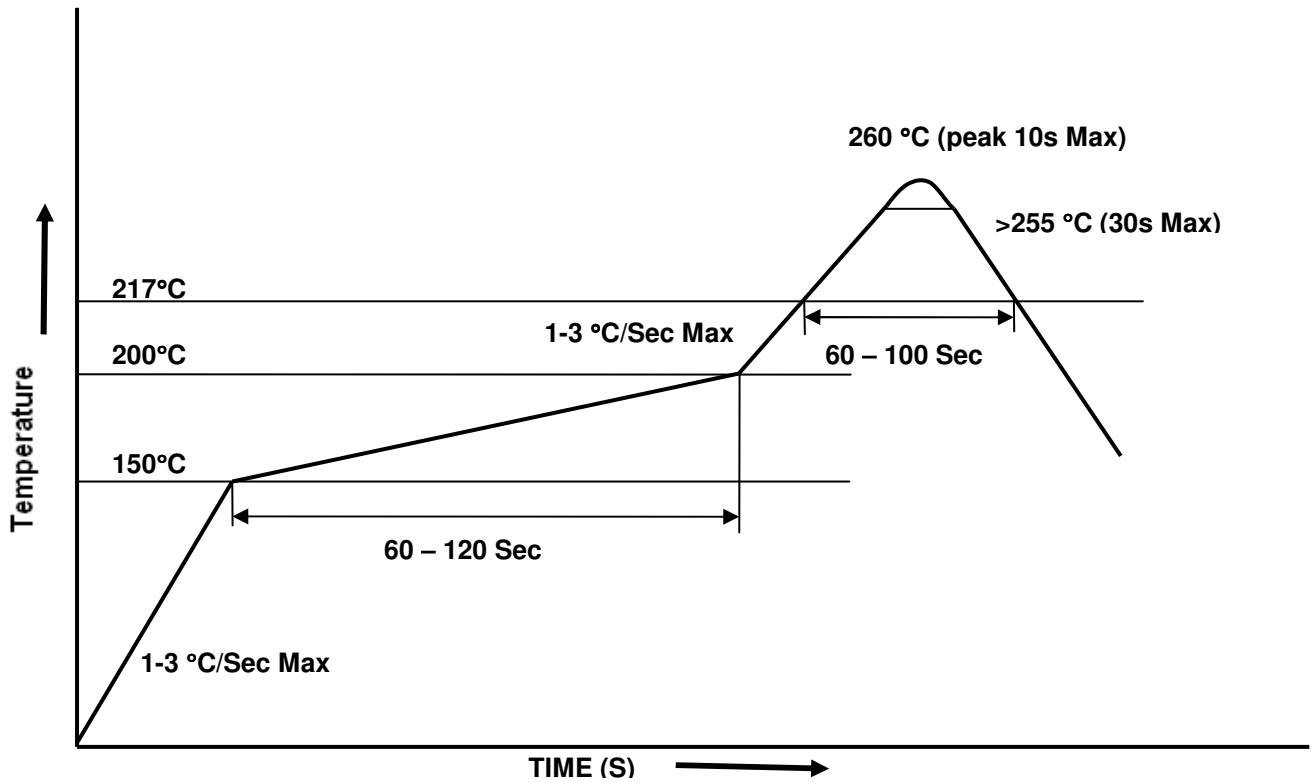

DISCLAIMER

1. The specifications in this datasheet may be changed without notice. EVERLIGHT reserves the authority on material change for above specification.
2. When using this product, please observe the absolute maximum ratings and the instructions for use as outlined in this datasheet. EVERLIGHT assumes no responsibility for any damage resulting from use of the product which does not comply with the absolute maximum ratings and the instructions included in this datasheet.
3. These specification sheets include materials protected under copyright of EVERLIGHT. Reproduction in any form is prohibited without the specific consent of EVERLIGHT.